

NU - TECK

NUFLEX FLEXIBLE GEAR COUPLINGS

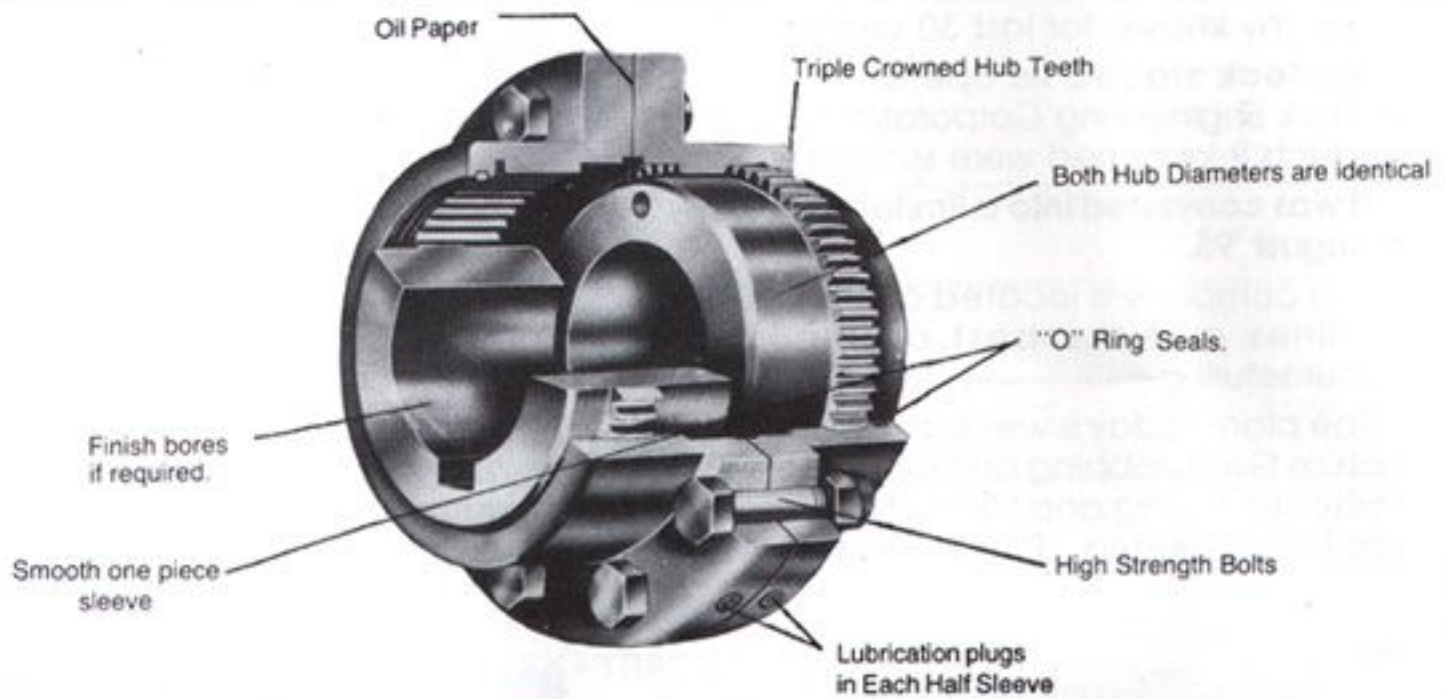

Under the misalignment condition of two shafts of the equipments, the teeth contact in case of straight cut hub will be as minimum as shown in the figure No. 1

Under heavy loads the ends of the hub teeth will get damaged resulting in the excessive play between hub & sleeve. And, therefore, the reduction in life of coupling.

NU-TECK TRIPLE-CROWNED TEETH

The triple crowned teeth hub is manufactured on a fully automatic hobbing machine with built in crowing attachment which is controlled by hydraulic & electronic systems.

Under the misalignment condition of two shafts on the equipment, due to the curvature on teeth flank the contact area is much more and therefore, there is increase in life of coupling.

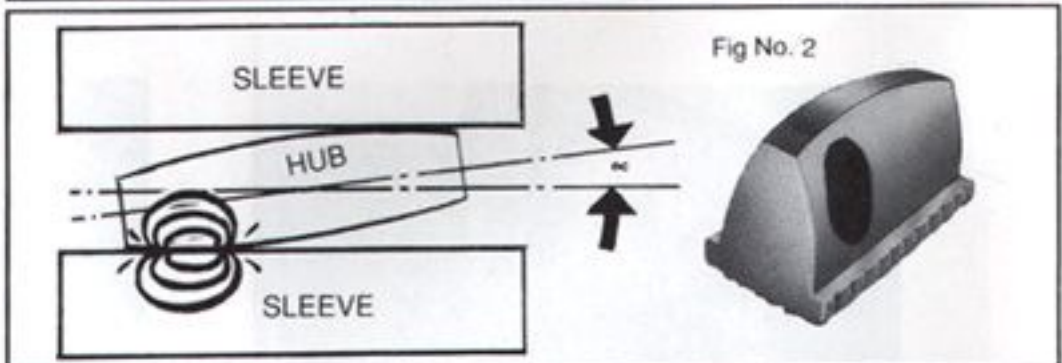
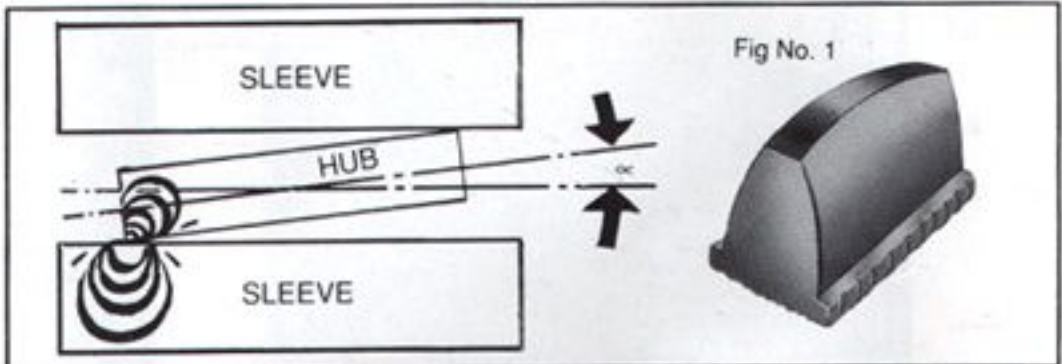

MISALIGNMENT DETAILS : In case of straight tooth gear coupling the maximum allowable angular misalignment (α) is 1.1/2 deg. and in case of NU-TECK Triple Crowned tooth Gear Coupling the misalignment is 7.1/2 deg.

SERVICE FACTORS

PRIME MOVER

Driven Unit (Mechinery)	PRIME MOVER		
	Electric Motor or Steam Turbine	Gasoline or Diesel Engine 4 or more Cyl.	Gasoline or Diesel Engine. more than 6 Cyl.
LIGHT Uniform of Steady load never exceeding horse power rating, infrequent starting : Agitators, Blowers, Can Filling Machines, Conveyors, Fans, Generators, Pumps, Steering Gear, Stokers.	1.0	1.5	2.0
MODERATE Heavy inertia, moderate shock, frequent starting : peak loads do not exceed 125 per cent average horsepower. Uneven load : Conveyors, Feeders, Welding, Laundry Washers, Mixers Paper Mills, Printing Presses, Screens, Textile Industry, Car Pullers.	1.5	2.0	2.5
HEAVY Heavy shock conditions or frequent reversing peak loads do not exceed 150 per cent average horse power. Uneven load. Cranes & Hoists, Crushers, Dredges, Elevators, Hammer Mills, Lumber Industry, Machine Tools, Metal Mills, Oil Industry, Rubber Industry Windlass.	2.0	2.5	3.0

NUFLEX FLEXIBLE GEAR COUPLING

Minimum clearance Required for Aligning Minimum clearance Required for Aligning

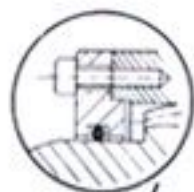

This cover plate construction for sizes GC-105 onwards.

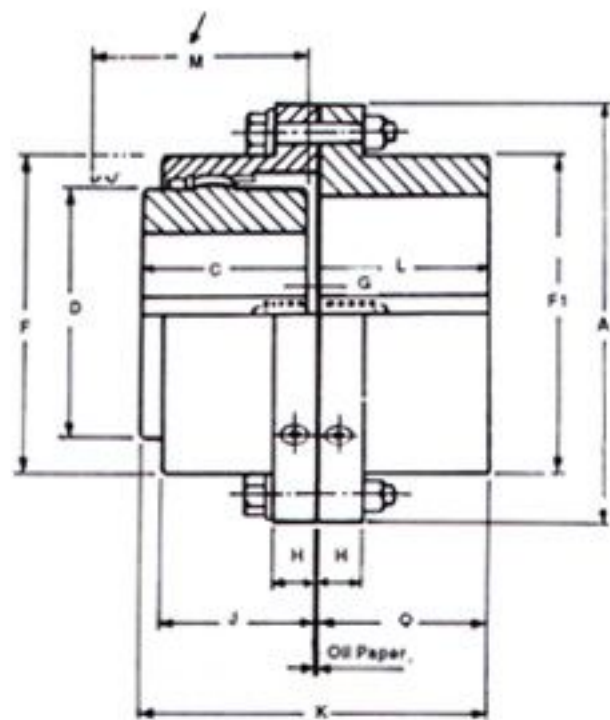
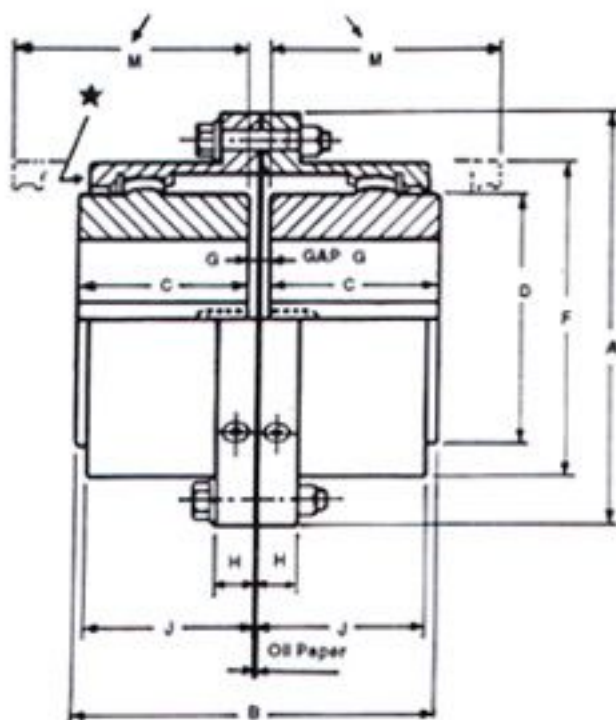

FULL FLEXIBLE TYPE

HALF FLEXIBLE TYPE

COMMON FOR BOTH COUPLINGS					FULL FLEXIBLE TYPE					HALF FLEXIBLE TYPE												
NU-TECK G.C. NO.	H. P. CAPACITY AT		Max. R. P.M.	BORE MIN	A	C	D	F	M	G	H	BORE Max.	J	B	WR ² Kgm ²	Wt. In Kg	K	O	BORE Max.	F1	WR ² Kgm ²	Wt. In Kg
	100	Max. Torque Kg. M.																				
GC-100	7	50	8000	10	120	45	50	75	55	1.5	15	32	40	93	0.03	4.5	93	46.5	45	70	0.04	5
GC-101	14	100	6300	20	170	55	65	110	65	2.5	17	45	49	115	0.14	11	115	57.5	60	85	0.15	11
GC-102	35	250	5000	30	185	70	85	125	80	2.5	17	60	62	145	0.20	15	145	72.5	75	110	0.24	15
GC-103	63	450	4000	40	220	85	105	150	105	2.5	20	75	78	175	0.48	25	175	87.5	90	130	0.51	20
GC-104	119	850	3350	50	250	105	130	175	125	2.5	20	90	96	215	0.95	39	215	107.5	110	160	1.0	40
GC-105	182	1300	2800	60	290	110	155	200	140	5	25	110	106	230	1.90	57	230	115	130	185	2.0	60
GC-106	280	2000	2500	75	320	125	175	230	155	5	25	125	117	260	3.00	85	260	130	150	215	3.3	80
GC-107	490	3500	2100	90	350	140	205	260	175	5	25	140	134	290	5.25	103	290	145	170	240	5.8	106
GC-108	630	4500	1900	105	380	155	230	290	190	5	25	160	147	320	8.50	138	320	160	200	285	9.5	149
GC-109	784	5600	1700	125	430	165	250	330	205	5	27	180	156	340	15.00	210	340	170	220	315	16.8	170
GC-110	1148	8200	1400	140	490	180	310	390	220	5	27	220	171	370	30.50	277	370	185	260	370	35.0	264
GC-111	1536	11000	1250	160	545	200	350	445	240	5	30	260	192	410	58	550	NOTE 1. Made to order / special Gear Couplings also can be manufactured 2. Dynamic balancing & Heat Treatment will be done on request.					
GC-112	2053	14700	1120	180	590	240	400	490	280	5	30	300	231	490	88	710						
GC-113	2793	20000	1000	200	680	270	440	555	310	7.5	35	330	242	535	138	980						
GC-114	3994	28600	900	220	730	280	500	610	330	7.5	35	370	266	575	291	1320						
GC-115	4852	34750	800	250	780	320	540	660	370	7.5	35	410	305	655	353	1700						

HOW TO SELECT THE RIGHT NUFLEX GEAR COUPLINGS

1. Select the size NUFLEX Coupling that will accommodate the diameter of the largest shaft. Usually this will determine the proper size Coupling for your application.
2. To make sure this Coupling has the required capacity : a) Check your application against the Service Factor Chart. b) Use the following formula to obtain the HP per 100 RPM of your application :

$$\frac{\text{HP} \times \text{Service Factor} \times 100}{\text{RPM}} = \text{HP} / 100 \text{ RPM}$$